

South Carolina Pursuant to a warrant from John Thomas Esq. Comr. of loc^{ns} in 9th District N. Saluda
 Dated 2nd May 1796, I have admeasured and laid out unto Martha Moore a tract of one hundred acres of land in said District on a branch of Needy river call^d Moore's branch waters of Saluda bounding S on John Moore, & on Henry Byers on other sides vacant land, and hath such Shape & Marks as the above Plat represents,

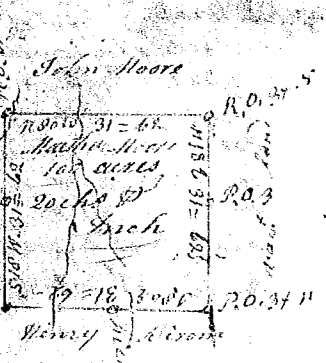

Survey 5th May 1796. John Rodgers Esq.
 Recorded 27th June 1796. Del. W^m Moore

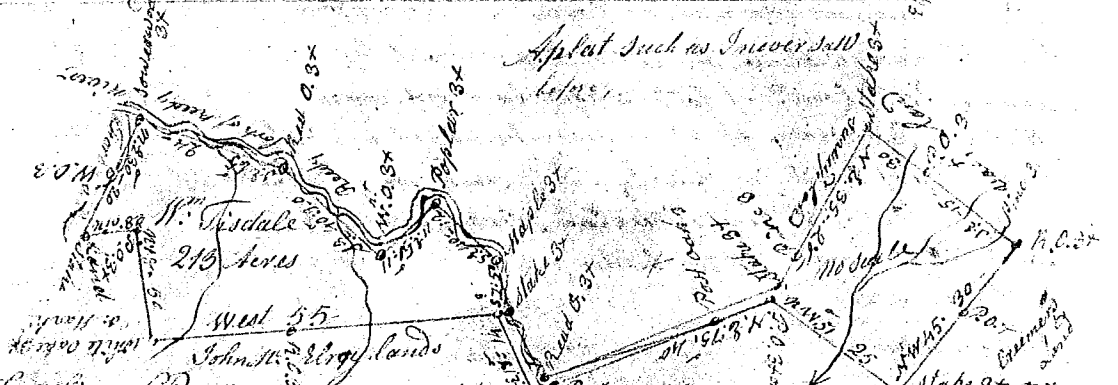

South Carolina Pursuant to a warrant from John Thomas Esq. Comr. of loc^{ns} N. side Saluda Dated 12th April 1796, I have measured and laid out unto William Tisdale a tract of two hundred thirty three acres of land lying in Greenville County on the heady fork of Needy River bounded Westwardly by William Coopers land, S. & N. wardly by John T. Byers & John T. Tisdale lands N. E. & by the Needy fork of Needy river, and hath such Shape, form & Marks as the above Plat represents, Certified to me this 15th May 1796. Del. H. W. W. Esq.
 Recorded 9th July 1796.

State of South Carolina Pursuant to a warrant from John Thomas Esq. Comr. of loc^{ns} N. side Saluda Dated 16th June 1796, I have admeasured and laid out unto the Hon^{ble} John T. Grimke a tract of one hundred and eighty seven acres of land on the branches of Frenchman's Creek in Union County, having such Shape, Markings & Boundings as the above Plat represents,

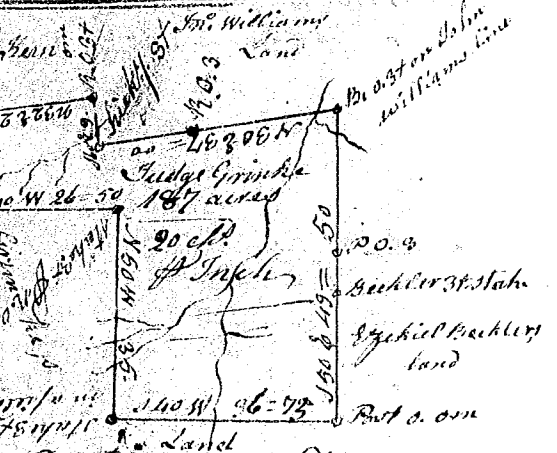

Survey 7th July 1796. Robt. Hanna Esq.
 Recorded 11th July 1796. Del. J. Picket

South Carolina Pursuant to a warrant from John Thomas Esq. Comr. of loc^{ns} in 9th District N. Saluda dated 15th April 1796, I have admeasured and laid out unto John Redman a tract of forty five acres of land in said District on a fork of Coopers Creek waters of Coopers river, having S. & E. with John Redman's land N. W. with Samuel Coopers land, & S. W. with William Willsons land, S. E. with Vanderhorst's land, and hath such Shape and Marks as the above Plat represents,

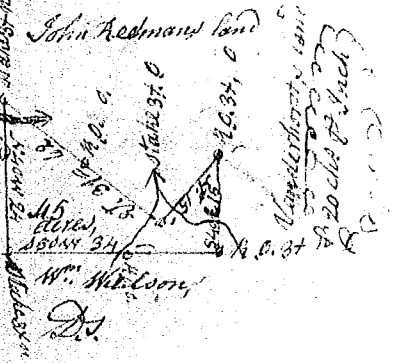

Survey 21st May 1796. Del. Wofford
 Recorded 14th July 1796. Del. Self